

Plantation Click

INSTALLTION GUIDE FOR PLANTATION LUXURY VINYL CLICK PLANKS

BEFORE YOU START

- The vinyl click planks are normally loose laid without adhesive, although full spread gluing is also possible, if required and recommended in areas with heavy rolling loads.
- The vinyl click planks need to be acclimated. Store flat and fully supported during shipping and storage. Remove material from packaging, spread out if possible and allow to condition in room where installation is to take place at a constant temperature between 68 and 77F or 200-250C for a period of 48 hours prior to installation.
- Check the vinyl click planks for possible defects **prior** to the installation. **Complaints can only be accepted before installation.** Slight variations in color and structure are designed to create a natural appearance. Mixing the sheets enhances this appearance.
- Be aware that when exposed to excessive temperatures and direct sunlight the vinyl click planks** may expand and contract causing problems with the locking system. Please consider these exposures when choosing your product.
- Facilities where walkers, wheel chairs (i.e. Residential and or extended care use, or in facilities with movement of heavy displays, racks, dentist chairs etc.) may exert extreme stress and compromise the locking system.
- Determine if there is a need for noise reduction.**

THE SUBFLOOR

- Although these luxury vinyl planks are water-resistant, they are **not** to be used as a moisture barrier. Your subfloor should be completely dry prior to installation.
- Subfloors must be structurally sound, solid, stable, level, plumb and true to a tolerance in plane of 3/16" in 10 foot (4.7 mm in 4 m) increments. Cracks and holes must be filled with a fast setting cement-based polymer modified patching compound or equivalent. Any unevenness over 3/16" (4.7mm) must be sanded down or leveled. The surface must be clean of dirt, oil, glue residue etc. Carpet staples or adhesive residue should be removed prior to installation. Voids or humps in the subfloor will prevent the planks from locking properly.
- The vinyl click planks can be installed on existing firm floors (Linoleum, PVC.), but all existing textile floors must be removed. When laying the floor over existing ceramic planks first level with fast setting cement-based polymer modified patching compound.
- "When installing in a condominium project that requires hight noise suppression between floors. We recommend using an underlayment approved for use under Luxury Vinyl!". Change the using and underlayment to "using a Underlayment approved for LVP installation. For concrete use only a moisture barrier"

MEASUREMENTS

- Agree with the client on which direction the floor boards should run since this influences the visual size ratio of the space. Installation parallel to the longest wall or the main light-source is recommended for best visual effects.
- Pre-plan the floor by measuring the room first. If the width of the last row is less than 5 cm (2") saw the first and the last plank in equal width.
- Snap A-lines on the substrate to identify the layout reference points - planks should be set using this reference to ensure planks are aligned and will lock together correctly.
- In large areas where flooring will span in excess of 40' long, an expansion gap should be used. Otherwise place expansion space in room-narrowing and in the door-rebate. Cover the expansion space with suitable coverings.

INSTALLATION

Different production runs

- Vinyl floors can have slight color variations between production runs. Before starting the installation, it is best to check the production run # which is indicated on the label on the carton. If you find that you have cartons from different production runs, it is highly recommended that you open cartons and install a mix of planks from each different production run on your floor. This will result in a more natural looking floor.

Do not install your luxury vinyl plank over soft subfloors such as carpet or foam underlayments.

- The use of Pull bar and tapping block is recommended to ensure a successful install.**
- The vinyl click planks provide a very tight fit. Proper care must be used to ensure all seams are tight at end of install. An unprofessional installation or use of improper tools can result in damage to the Click planks.

First row:

- Diagram #1 Start with the first sheet in the left corner of the room, tongue-side facing out from the wall on the length and to the right on the width. Work from left to right.
- Diagram #2 Position the following sheets as an exact extension of the first one.
- Cut to fit the last sheet of the row. To do this you can use a utility knife to score the surface at the appropriate point and then break the tile over an edge. A laminate cutter or Mitre saw can be used as well.

Following rows:

- Diagram #3 Begin the second row with the cut-off end to start the next and subsequent rows. Allow at least a 6" stagger for end seams. For positioning the planks together, starting with the first tile in the row, raise the tile at a 450 degree angle, insert the lengthways tongue into the lengthways groove and lower the sheet while holding the two together until they are flat and tight together. Close the joint using hand pressure .
- Diagram #4 Lever the next sheet in place from the front side so that only a very short distance remains for it to be pushed into the lengthways connection.
- Diagram # 5, 6, 7 Raise the sheet slightly and push it into the lengthways tongue, first close to the front connection then the rest. Make sure seams are tight on ends and sides using pull bar or tapping block before proceeding. Continue the installation to the last row of sheets, as described.
- How to shorten door frames: Position a loose sheet face down close to the door frame and cut with a jamb saw.
- People can walk on the flooring immediately after the installation. Remove the wedges. Nail or screw moldings to the wall, never to the floor.

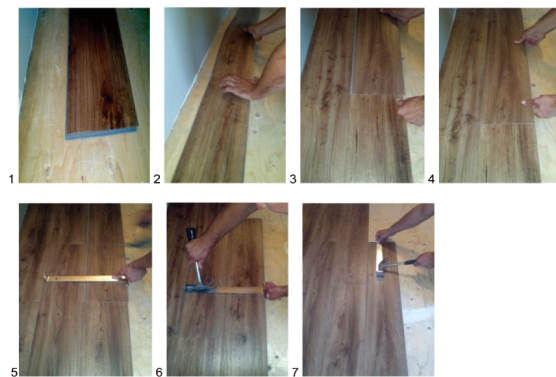

INSTALLATION IN DIRECT SUNLIGHT

For application in direct sunlight or exposure to excessive heat or in areas with rolling traffic i.e. wheelchairs or dollies it is recommended to use Harbinger seam sealer on end seams during installation. Seam Sealer should be applied to the flange of the tile or plank and slid in. Make sure to wipe off the top of seam edge with a damp cloth to remove any excess as you are installing

MAINTENANCE

Clean regularly with a damp mop with a vinyl floor cleaner such as Capture Vinyl Floor Cleaner or Laminator Plus. Do not use excessive water. **Always** use Chair Protectors under furniture and on chair legs. Teflon protectors are best .

10-YEAR COMMERCIAL / 25-YEAR RESIDENTIAL WARRANTY

Our 10-Year Limited Commercial Warranty for the vinyl click planks means that for ten years, from the date of purchase, your floor will be free from manufacturing defects and will not wear through when installed and maintained according to the instructions supplied with each carton. This guarantee applies only to the original end user and proof of purchase is required for all claims. The guarantee is for replacement or refund of the material only, no labor. Claims for wear must show a minimum dime size area. High-heeled shoes, rolling carts, furniture and chairs without protective pads can damage the floor and are not covered by this warranty.